

Message boards to be placed
at least 1 week in advance

Road
closed at
crossing
3/18/22 to
3/20/22

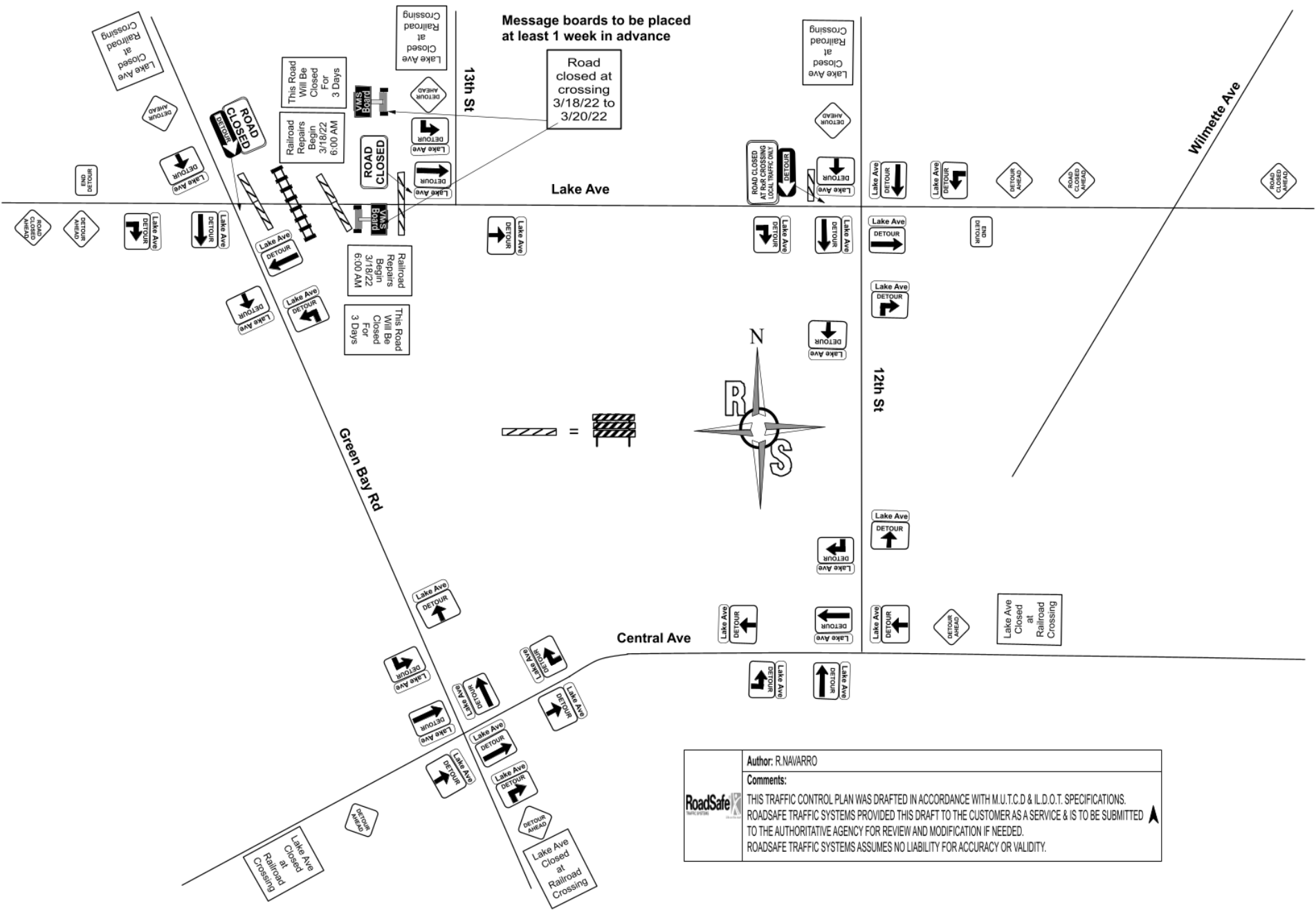

	<p>Author: R.NAVARRO</p> <p>Comments: THIS TRAFFIC CONTROL PLAN WAS DRAFTED IN ACCORDANCE WITH M.U.T.C.D & I.L.D.O.T. SPECIFICATIONS. ROADSAFE TRAFFIC SYSTEMS PROVIDED THIS DRAFT TO THE CUSTOMER AS A SERVICE & IS TO BE SUBMITTED TO THE AUTHORITATIVE AGENCY FOR REVIEW AND MODIFICATION IF NEEDED. ROADSAFE TRAFFIC SYSTEMS ASSUMES NO LIABILITY FOR ACCURACY OR VALIDITY.</p>
--	--